

## WALLY B



<i>Year:</i>	<b>1998 / Reift 2000 - 2002</b>	<i>Builder:</i>	<b>Wally / Pendennis Shipyard UK</b>
<i>Flag:</i>	<b>Luxembourg</b>	<i>Construction:</i>	<b>Advanced Composite</b>
<i>LOA:</i>	<b>107.4'/32.72 m</b>	<i>Type:</i>	<b>Fast Cruising Sloop</b>
<i>LWL:</i>	<b>94.3'/28.72 m</b>	<i>Naval Arch.:</i>	<b>Luca Brenta &amp; C</b>
<i>Beam:</i>	<b>26'/7.92 m</b>	<i>Engines:</i>	<b>Scania 385 hp</b>
<i>Max Draft:</i>	<b>15.9'/4.80 m</b>	<i>Propulsion:</i>	<b>3 blades, max prop</b>
<i>Disp. Ton:</i>	<b>75.4 tons</b>	<i>Max. Speed:</i>	<b>NA</b>
<i>Fuel:</i>	<b>4300 litres</b>	<i>Cruising</i>	<b>12 knots</b>
<i>Water:</i>	<b>2500 litres</b>	<i>Guest Accom.:</i>	<b>6 guests in 3 cabins</b>
<i>Sail Area:</i>	<b>507.6 sq. m</b>	<i>Crew Accom.:</i>	<b>6 crew in 3 cabins</b>
<i>Price:</i>	<b>Euro 6,900,000</b>	<i>Location:</i>	<b>Palma, Spain</b>

## **CONSTRUCTION DETAILS**

Built in 1998 in Composite by Wally Yachts at Pendennis Shipyard, designed by Luca Brenta.  
Refitted at Composite Works 2000 – 2002.

## **ACCOMMODATION**

The interior layout features the crew-service area aft, and the owner-guest area forward. In between are the main saloon, the galley and the navigation area that form one voluminous living space around the central oval engine room. The interiors of Wally B designed by the architects Lazzarini and Pickering from Rome feature an innovative design that combines and integrates together the different living spaces of the social area in order to be very versatile. This system provides the opportunity to modify the layout according to various situations and requirements.

- Forward full width OWNER'S STATEROOM with Queen size bed, two wash basins, one bath tub Japanese style, separate head and shower.
- Forward starboard GUEST CABIN with Queen size bed, separate head and shower.
- Forward port GUEST CABIN with Queen size bed, separate head and shower.
- Main saloon and dining area with table and seats for up to 14 guests.
- Crew mess port side aft.
- Aft starboard CAPTAIN'S CABIN with double bed, separate head and shower.
- Aft port CREW CABIN with two beds and separate head.
- Aft starboard CREW CABIN with 2 beds and separate head.
- Crew separate shower.

## **ELECTRICAL DETAILS**

- 2 x 20 kW 50 Hz Tri-phase 220V Kohler generators
- 40 hp Yanmar with PTO for hydraulic power
- 2 x 12x2V Deep Cycle Gel batteries banks

## **MECHANICAL AND ENGINE EQUIPMENT:**

- 385 hp Scania engine
- Twin disc gearbox
- Mechanical direct propulsion
- 3-blade Max-Prop propeller
- 2-blade Max Prop propeller for racing
- Max Power 321 bow thruster
- Max Power 321 stern thrusters
- Condaria air conditioning
- Racor 2020 Primary fuel and water separators

## **ELECTRONIC AND NAVIGATIONAL EQUIPMENT**

GPS	Leica (AP Navigator)
Satcom	Satcom C Fishery Capsat TT 3022D-Satcom Mini M Nera World Phone
Marine	
Depth-Sounder	B&G
Wind Instruments	B&G
Speedometer	B&G
VHF	Shipmate RS 8300
SSB	Furuno
Radar and Model	Furuno Marine Radar 821 / 841
Cellular	Nokia GSM/GPRS

## **DECK SAFETY EQUIPMENT**

- 115 kg Danforth anchor
- Lewmar anchor windlass
- Lewmar mooring winches
- Harken deck fittings and fixtures
- Custom carbon/hydraulic passerelle
- Jon buoys
- AutoFlug sof-bag life-rafts (8 man)
- Fully equipped grab-bags
- EPIRB

## **TENDERS & TOYS:**

Tender	Zodiac 4.7 m / 70 hp Yamaha
Support Boat	Scorpion 7.5 m / 200hp Yamaha

## **SAILS AND RIGGING**

- Southern Spars carbon mast and boom
- Riggarna rigging
- Sails by North Sails:
  - 3DL carbon/Kevlar full battened main
  - Wally Furling self-tacking jib
  - Overlapping Jib
  - 10,000 sqft running gennaker (black)
  - 7,000 sqft reaching gennaker (white)
    - 2 x racing socks for above
  - Spectra storm jib (orange trim)
- Harken deck hardware
- Reckman furling jib
- Navtec/Cariboni rams

## **GALLEY & LAUNDRY EQUIPMENT**

- Miele KM 440 Halogen ceramic hob - 4 burners
- Miele M636C combination microwave/convection oven and grill
- Emerson electric “in-sink-erator” 50 Waste disposal
- Saeco sup 015 automatic espresso coffee machine
- 2 x Frigomar food freezers
- 3 x Frigomar food fridges
- 2 x Frigomar drinks fridges
- Frigomar ice maker
- Miele WS 5408 electronic washing machine
- Miele T 5206 tumble dryer with extractor

## **HOUSEKEEPING**

- IMERGE Soundserver
- FUJITSU plasma screen
- LINN Sound
- DVD
- Video
- Sat-TV

All of the above systems are integrated into a “Touch Screen” facility throughout the yacht. This is an Ebacos system which can be continually modified and upgraded as required.

Wally B Photos



Master Cabin



Starboard Cabin



Saloon / Nav. Area



Saloon



Galley

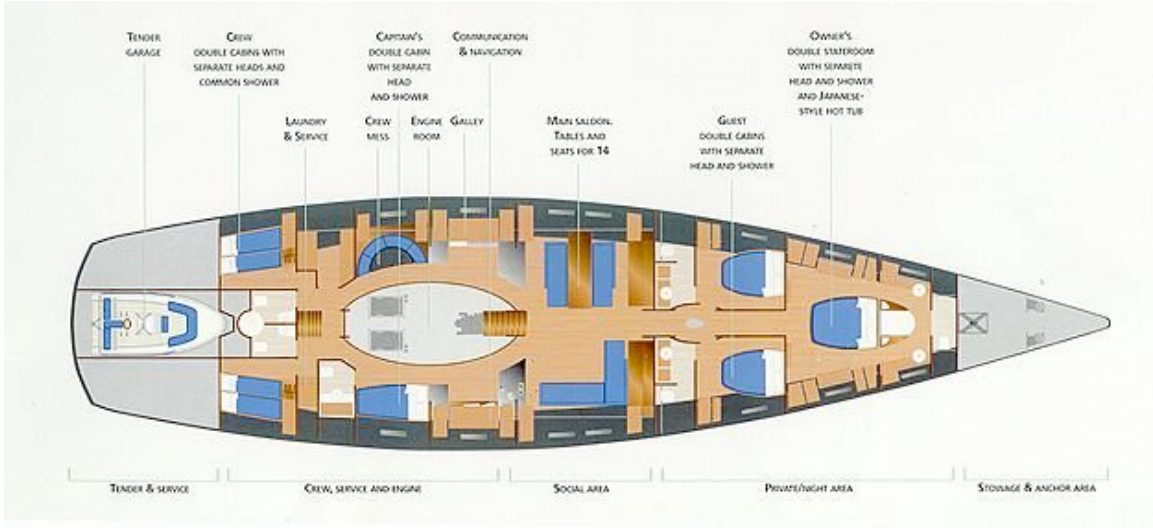

These particulars are believed to be correct but not guaranteed nor used for contractual purposes. Any advertising of this vessel in print or digital form is prohibited without written permission of BCR Yachts.